



Aria Jellyfish - A.JF\_A01  
rev. 1.1\_01/02/2019

## General description

Bluetooth controllable, Casambi enabled, DIN RAIL (4 modules) 4 input 4 output interface, with feedback led and multivoltage power supply. It can be connected, only by qualified professionals. Can be controlled via PLH Aria keypads (PLH Neo Lighter, PLH Neo, PLH MakeUp Aria), and with Casambi app available for iOS (iPhone 4S or later, iPad 3 or later, iPod Touch 5th gen or later) and Android devices (Android 4.4 KitKat or later devices produced after 2013 with full Bluetooth 4.0 support).

## Technical specifications

Voltage range and frequency	110 - 230 V ~	100 - 240 V~ (1 VA) 50-60 Hz
Voltage range	24 V =	18 - 30 V = (1W)
Input	Dry contact	4 NO to ground and pass through
Output	Transistor	4 (100mA and 30V = max); open-collector to GND; control of inductive load allowed (with relays)
Feedback		Led white (output) and blue (input) on board
Maximum output radio transceiver power:		2,4...2,483 Ghz +4 dBm
Range (depending on the surroundings)		up to 15 m
Contains FCC ID:		2ALA3-CBM002A
Contains IC		22496-CBM002A
Wiring and connections		terminal block wires max 1,5 mm <sup>2</sup>
Dimensions:		90,0 x 52,5 x 58,0 mm
Weight:		140 g
Degree of protection:		IP20
Ambient temperature, ta:		- 20 ... + 45 °C
Max. case temperature, tc:		+ 65 °C
Max. relative humidity:		0...80%, non-cond.
Mark and regulations		

## Casambi Profile

5081	OUT: 4 Switch (relais bistable) - 0 Push button (relais monostable)	IN: 4 dry contact
5082	OUT: 3 Switch (relais bistable) - 1 Push button (relais monostable)	IN: 4 dry contact
5083	OUT: 2 Switch (relais bistable) - 2 Push button (relais monostable)	IN: 4 dry contact
5084	OUT: 1 Switch (relais bistable) - 3 Push button (relais monostable)	IN: 4 dry contact
5085	OUT: 0 Switch (relais bistable) - 4 Push button (relais monostable)	IN: 4 dry contact
5975	OUT: 4 Pwm	IN: 4 dry contact

## Installation

Make sure that the mains voltage is switched off when making any connections. Install the interface using the DIN Rail clamps on the back of the plastic box.

Follow the local regulation and IEC rules for the installation. Screws the wires in the right connectors for power supply.

The PLH Jellyfish is supplied with the 5085 firmware preinstalled

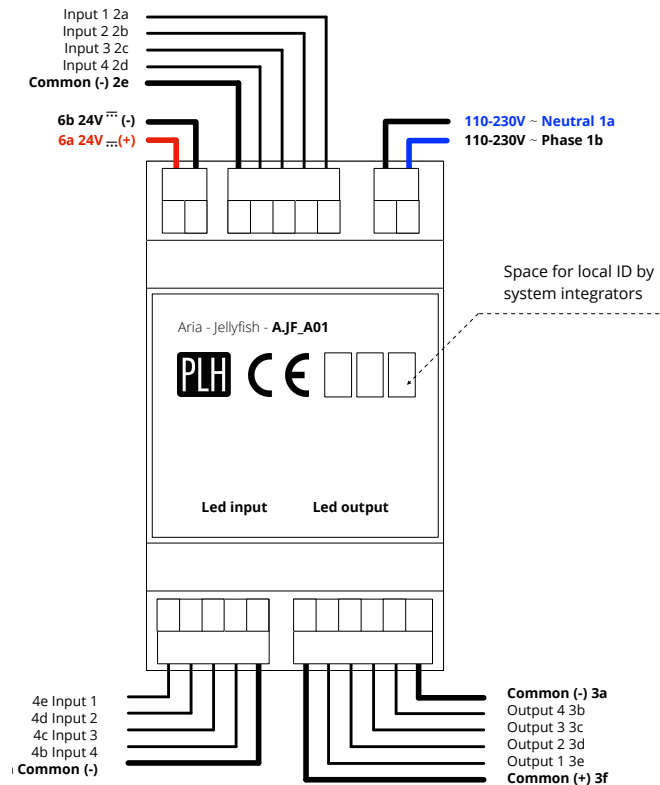

**Hazardous voltages. Risk of electric shock or fire.**

**Only qualified professionals should make the connections in accordance with the local regulations and rules. Disconnect the mains power supply and verify its absence prior to installation.**

## Warranty

We reserve the right to make technical and formal changes to the product in the interest of technical progress. Our products are under guarantee within the scope of the statutory provisions.

If you have a warranty claim, please contact PLH by e@mail ([support@plhitalia.com](mailto:support@plhitalia.com)) or the Local Reseller.



**This product should not be disposed of with household waste.**

**Please recycle the products where facilities for electronic waste exist.**

**Check with your local authorities for recycling advice.**

**Example 1: connection with BUS dry contact interface Gira 1119 00 Konnex interface**

In this solution you can control directly, using a PLH Aria keypad or a smartphone, a KNX bus system via a bus dry contact interface. Power supply need to be granted (230V AC or maximum 30V DC using the right wires)

Refer to Gira Interface specification document for any further information

<http://download.gira.com/data3/11193290.pdf>

Firmware 5085 PLH Jellyfish

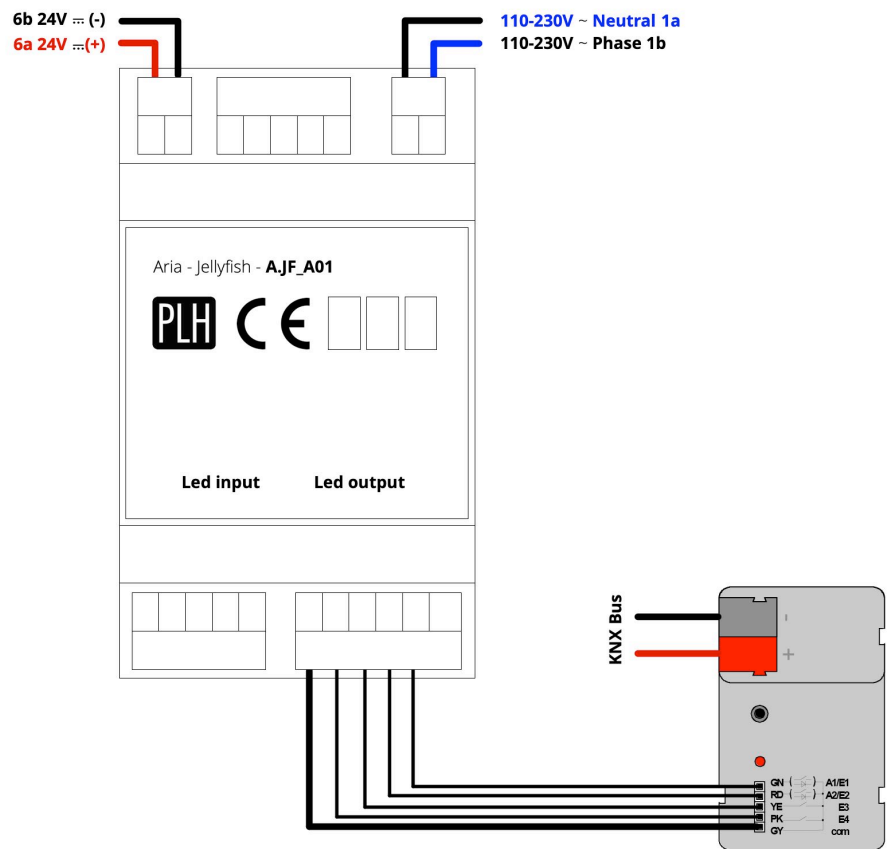

**Example 2: connection with BUS dry contact interface Philips LCU2070 DALI interface**

In this solution you can control directly, using a PLH Aria keypad or a smartphone, a Dali bus system via a bus dry contact interface. Power supply need to be granted (230V AC or maximum 30V DC using the right wires)

Refer to Philips Interface specification document for any further information

<http://www.assets.lighting.philips.com/is/content/PhilipsLighting/a7f5741c4ff54b2c90e4a68f00b8c881>

Firmware 5085 PLH Jellyfish

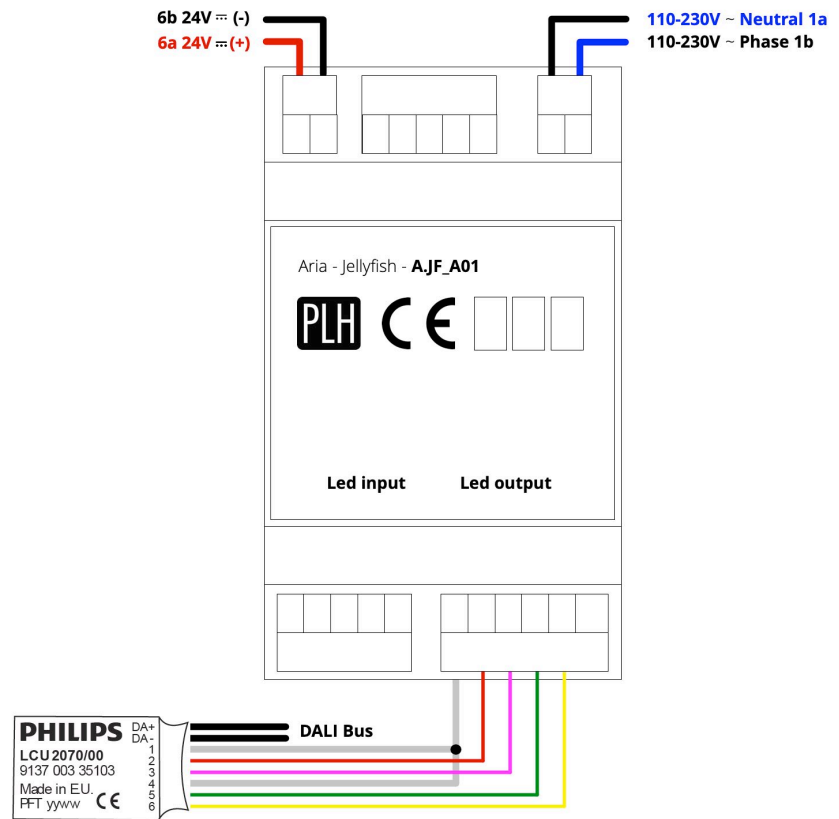

**Example 3: connection with BUS dry contact interface C2N-UNI8IO Crestron interface**

In this solution you can control directly, using a PLH Aria keypad or a smartphone, a **Cresnet bus system** via a dry contact interface. Power supply need to be granted (230V AC or maximum 30V DC using the right wires)

Refer to Crestron Interface specification document for any further information

[https://www.crestron.com/getmedia/41ce847e-5535-492f-a1df-298812b77537/ss\\_c2n-uni8io\\_1](https://www.crestron.com/getmedia/41ce847e-5535-492f-a1df-298812b77537/ss_c2n-uni8io_1)

Firmware 5085 PLH Jellyfish

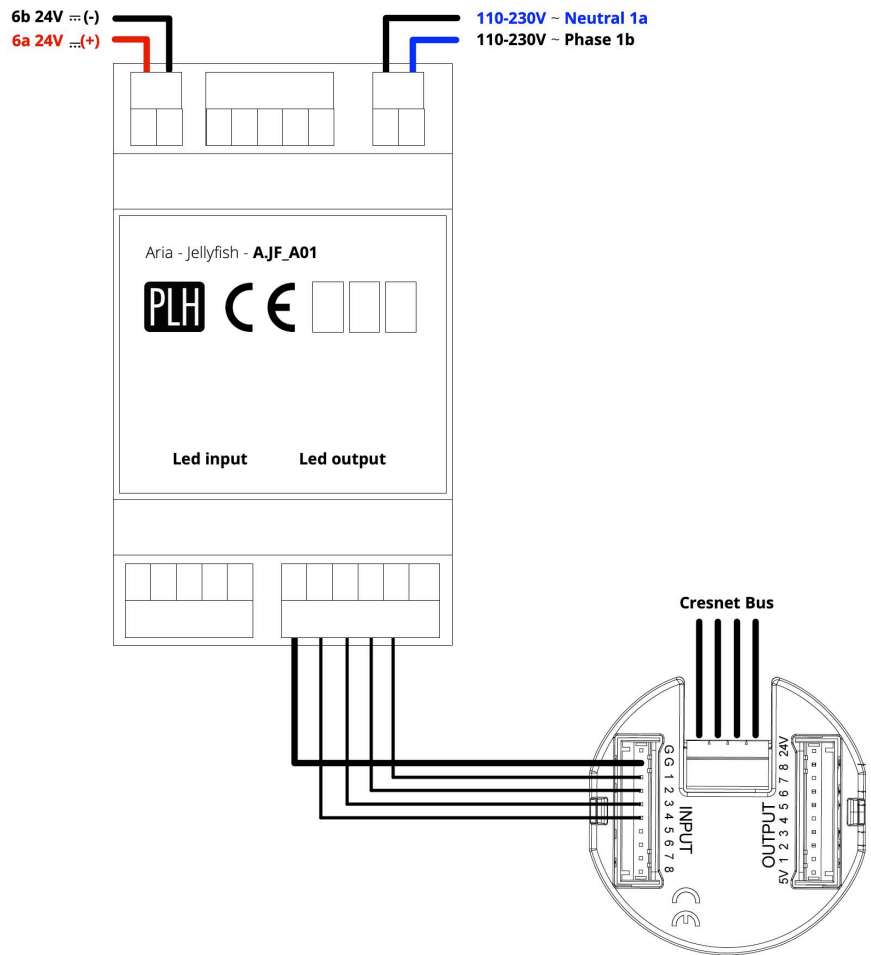

**Example 4: connection with BUS dry contact interface QSE-CI-WCI Lutron interface**

In this solution you can control directly, using a PLH Aria keypad or a smartphone, a **Lutron bus system** via a dry contact interface. Power supply need to be granted (230V AC or maximum 30V DC using the right wires)

Refer to Lutron Interface specification document for any further information  
<http://www.lutron.com/TechnicalDocumentLibrary/369681a.pdf>

Firmware 5085 PLH Jellyfish

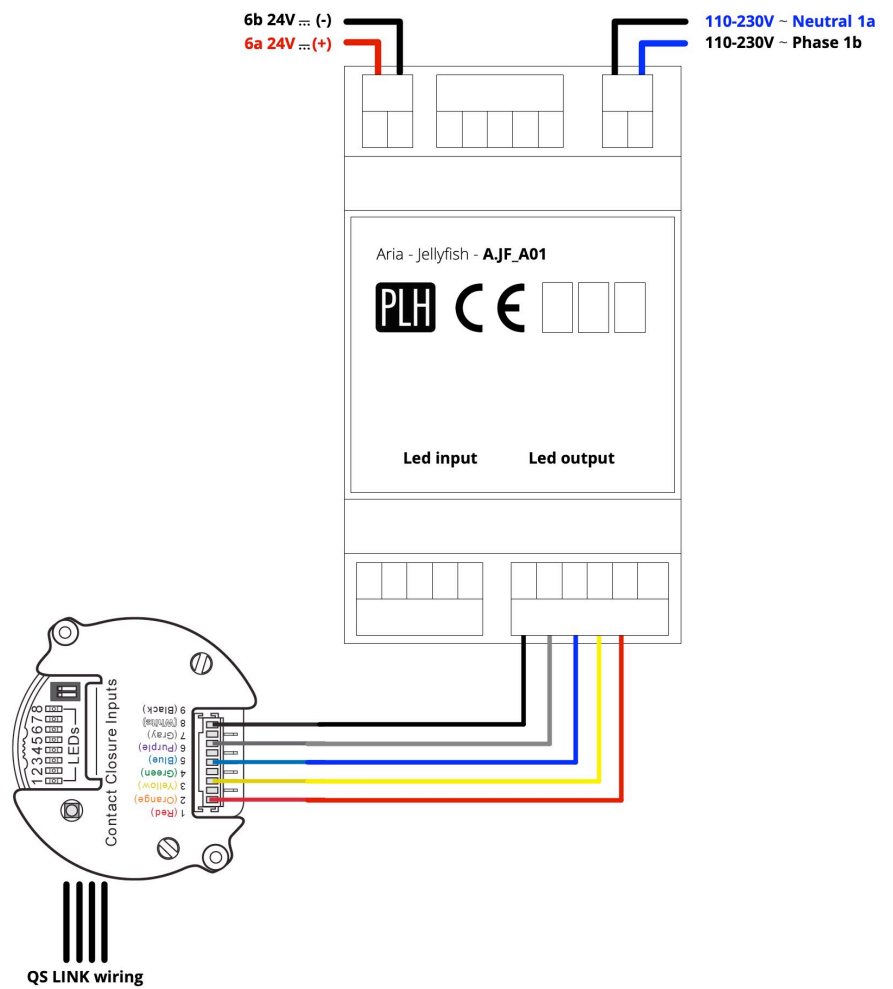

### Example 5: connection with relays bistable

In this solution you can control directly, using a PLH Aria keypad or a smartphone or a local normally open push buttons (4 in this scheme), **relays** with coil in extra low tension and contact in 230V (for example Finder 46 series) and **24 V leds**. Power supply need to be granted (230V AC or maximum 30V DC using the right wires)  
Firmware 5083

Use power supply 24V ...  
with fuse max 2,5A

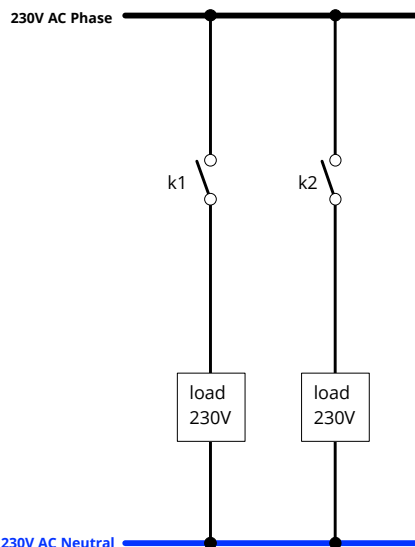
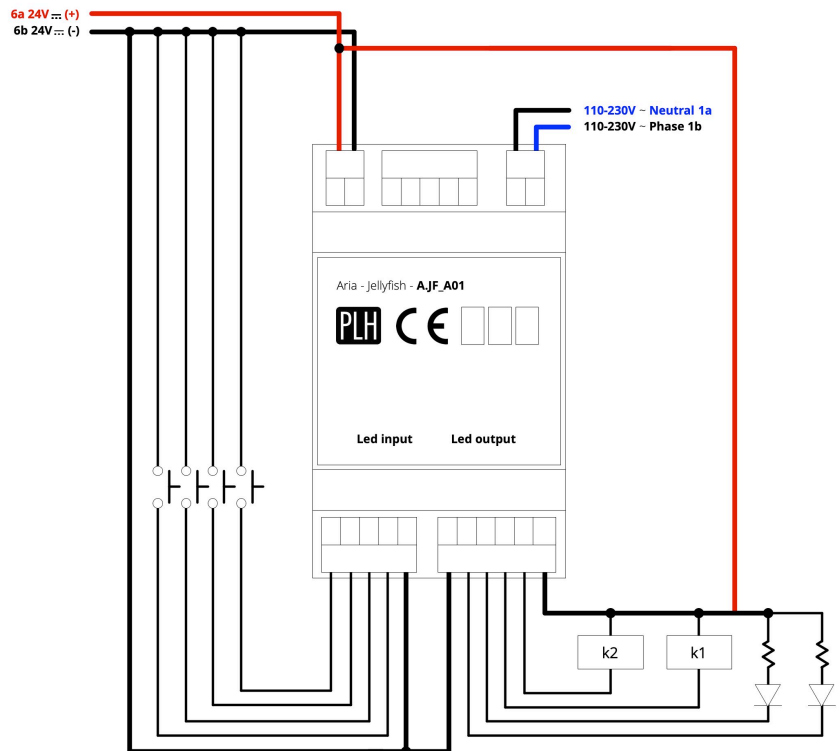



**Example 6: control of curtains**

In this solution you can control 2 curtains at 230V AC directly, using a PLH Aria keypad or a smartphone or a local normally open push buttons (4 in this scheme), relays with mechanical interlock with coil in extra low tension and contact in 230V. Power supply need to be granted (230V AC or maximum 30V DC using the right wires)

Firmware 5085

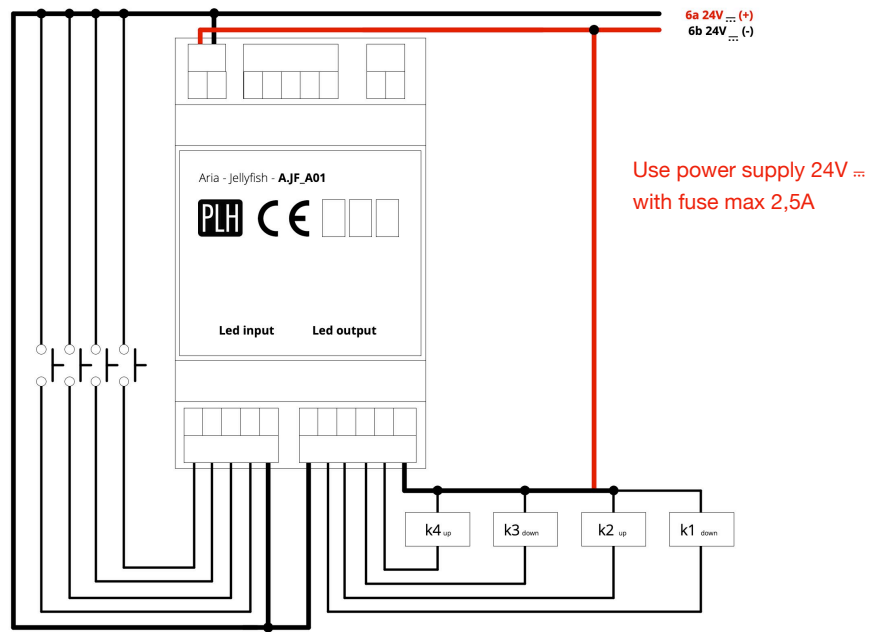

Finder 46 series

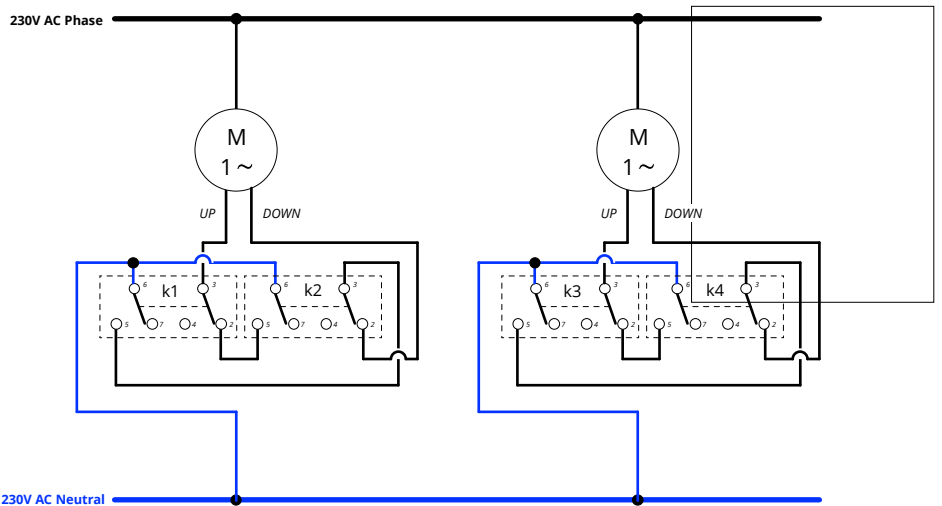

### Example7: control of single channel D-PWM ballast

In this solution you can control, using a PLH Aria keypad or a smartphone, a PWM dimmer led. Power supply need to be granted (230V AC or maximum 30V DC using the right wires)

Refer to Dalcnet specification document for any further information

[http://www.dalcnet.com/wp-content/uploads/DLA1248\\_1CH\\_ita.pdf](http://www.dalcnet.com/wp-content/uploads/DLA1248_1CH_ita.pdf)

Firmware 5975 PLH Jellyfish

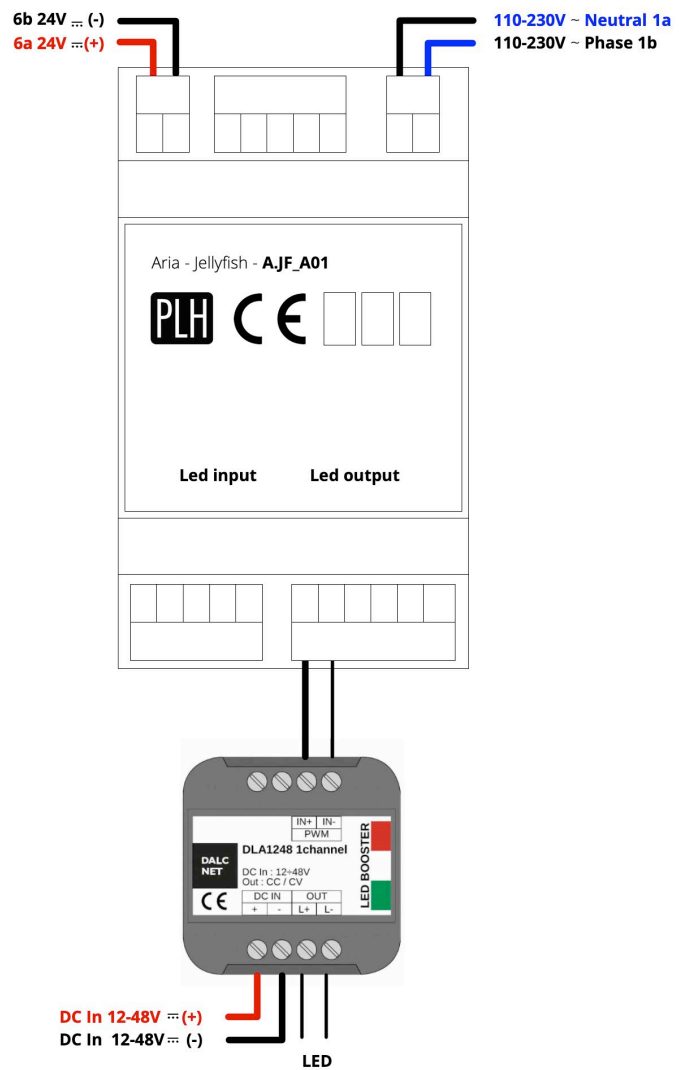

### Example8: control of multi channel D-PWM ballast

In this solution you can control, using a PLH Aria keypad or a smartphone, a PWM multi dimmer led.

Power supply need to be granted (230V AC or maximum 30V DC using the right wires)

Refer to Dalcnet specification document for any further information

[http://www.dalcnet.com/wp-content/uploads/DLA1224\\_4CH\\_ita.pdf](http://www.dalcnet.com/wp-content/uploads/DLA1224_4CH_ita.pdf)

Firmware 5975 PLH Jellyfish

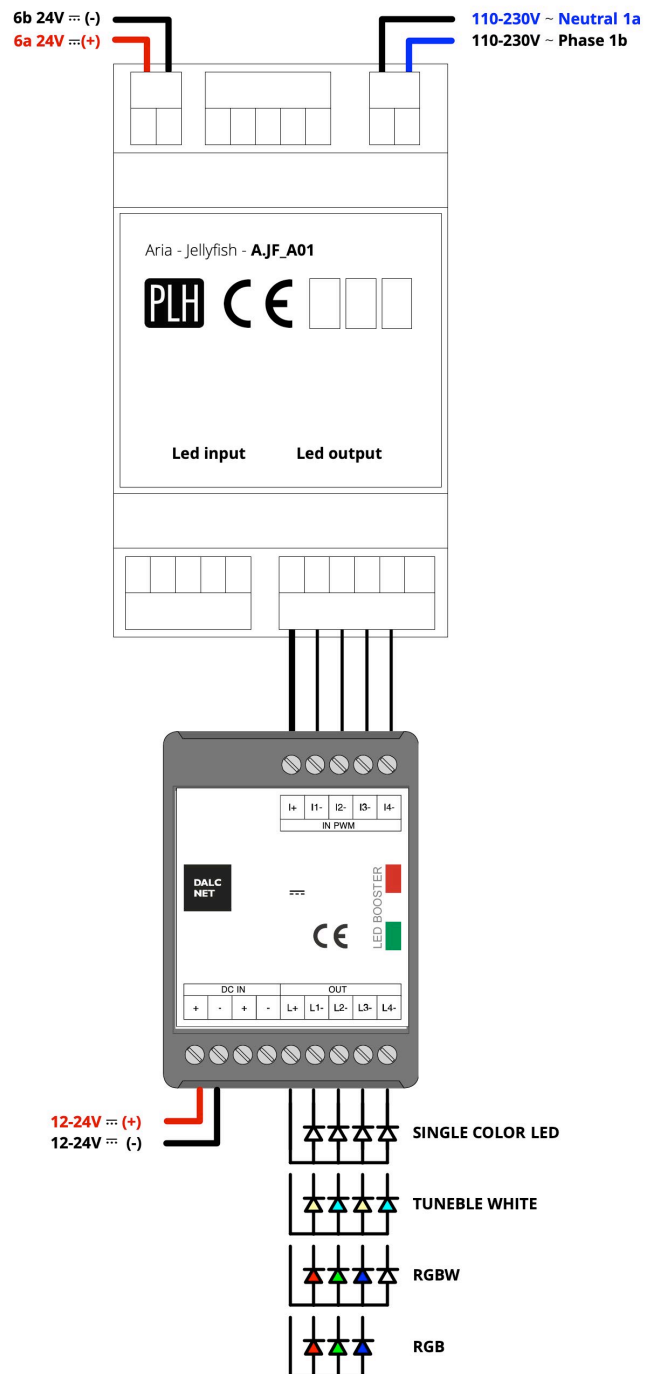

### 1. Download the app

Download the free Casambi App directly from the AppStore or the Google Play



For all the functionality of the Casambi App download the Short User Guide from the Casambi website <https://casambi.com/static/datasheets/Short-user-guide.pdf>

### 2. Open the App

Before you open the app be carefull about this points:

- the Bluetooth need to be **ON** on your smartphone or tablet
- have done all the updates of the operating system;
- have done all the connections of the PLH Jellyfish, like in the examples above
- have the power **OFF** of the PLH Jellyfish. You can connect it at 24 V ~ or 230 V ~

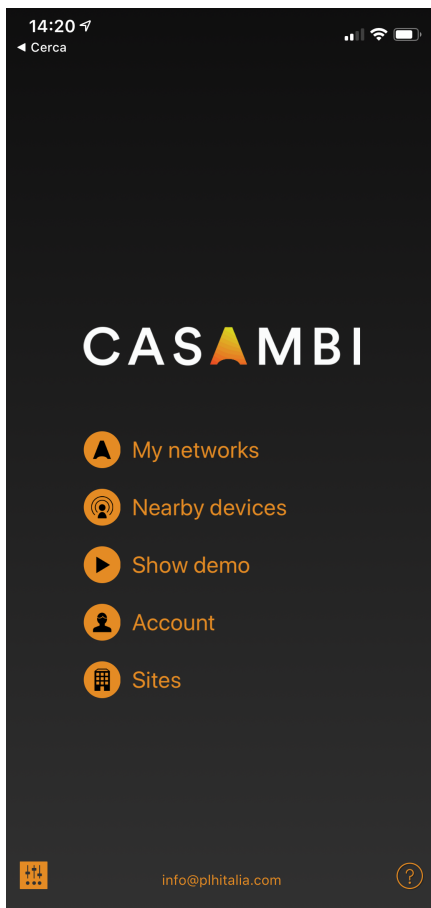

### 3. Create the network

Create the **New network** like in the picture  
If you want to control your luminaires from more than one mobile device you need to change the network sharing settings.

As a default the created network is not shared and only stored in the device that created it.

1. Tap on the **Sharing** and the 'Sharing mode' screen will open.
2. There are four different sharing modes: Not Shared, Administrator only, Password protected and Open.
- When you select Administrator only, Password protected or Open mode the network will be uploaded to cloud server and then it can be accessed also from other mobile devices.
3. Add also email address and password for the network.
4. Confirm your settings with 'Save'.

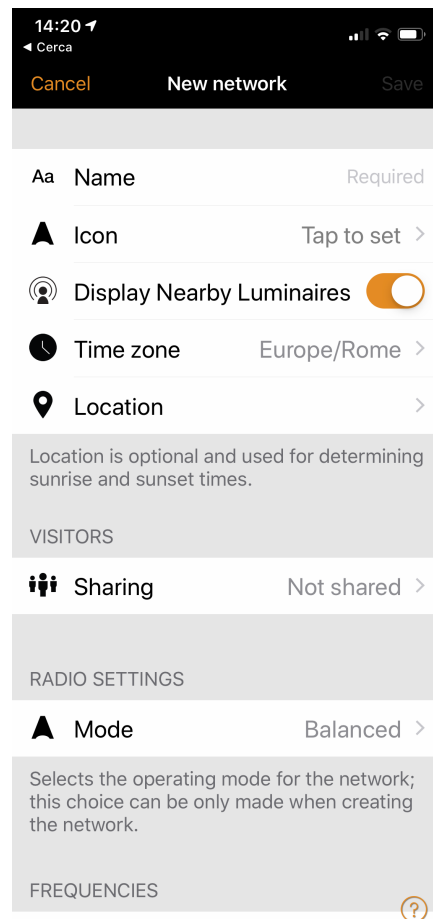

### 4. Add the device

Turn the power on of the Jellyfish and a window 'Found a new device' will appear.  
Then click on **Add to...** and add to your new network

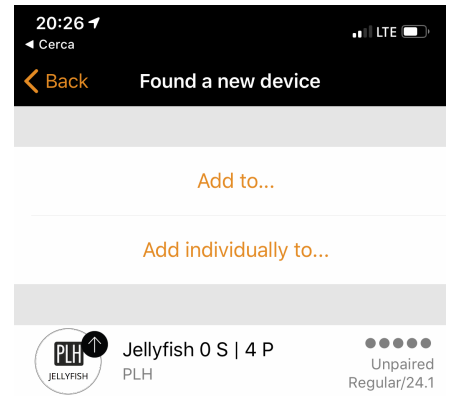

### 5. Control the Jellyfish

From the menu Luminaires you will be able to see the Jellyfish and all the Casambi Devices that are installed in your Network.

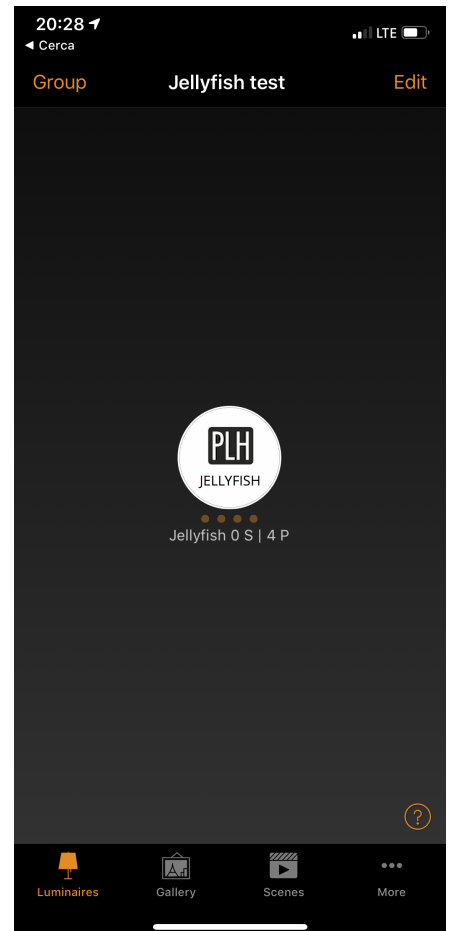

A long press on the icon will allow you to control the Jellyfish. The window will change depending of the type of firmware you have installed. Clicking on the related button / switch or slider will control the output.

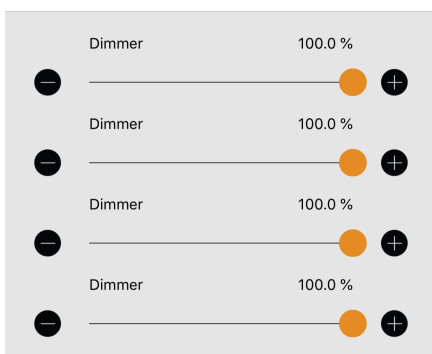
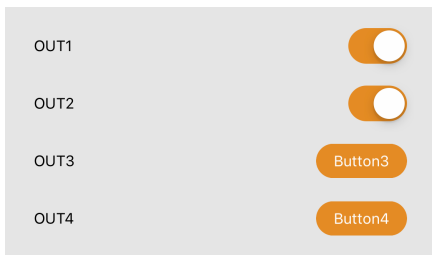
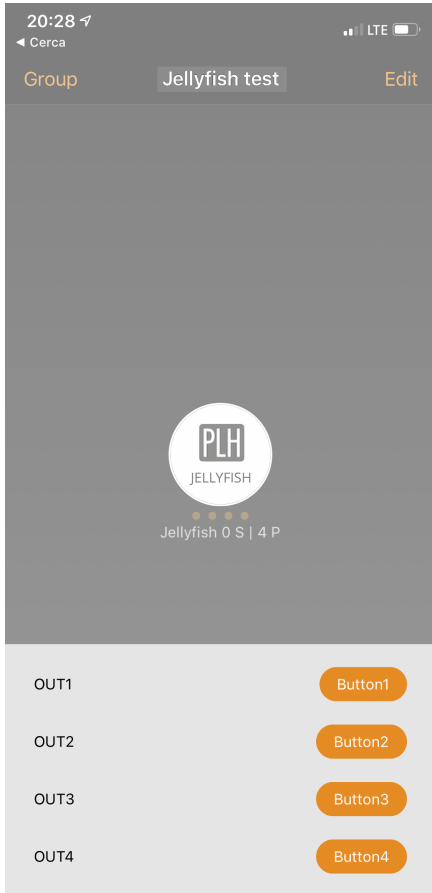

**6. Change number of buttons and labels**

A click on the text give you the chance to modify the labels

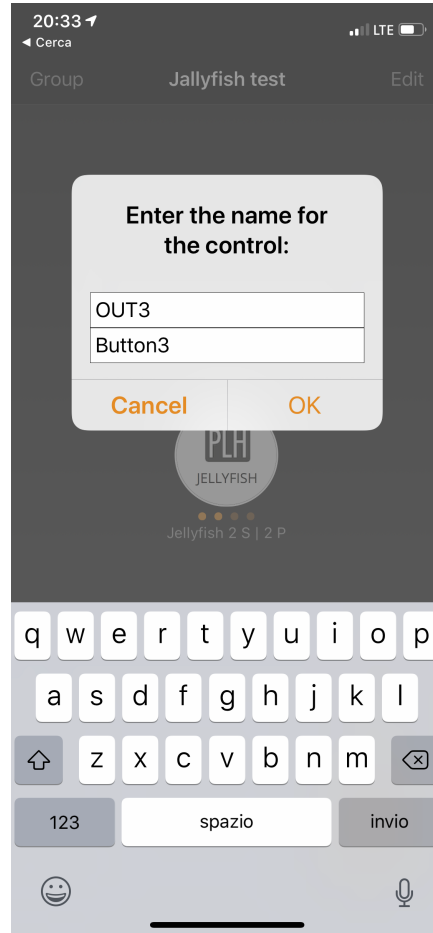

**7. Jellyfish parameters**

A double click on the icon of the Jellyfish will allow you to change all the parameters of the PLH device, like in detail:

- the state;
- the functionality of the input channels;
- the startup state;
- the name;
- the icon;
- the model.: firmware installed;
- the iBeacon option
- the Unpair command

Surf from the menù and change the parameters you want to modify

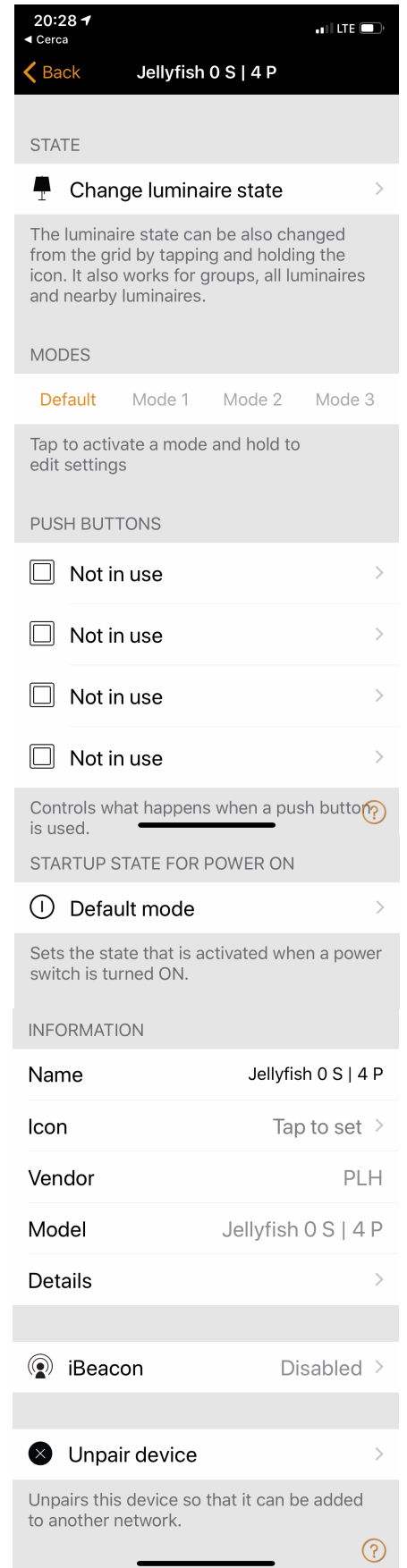

**8. Assign input functionality**

The PLH Jellyfish is supplied with 4 inputs dry contact connector.

You can be able to connect normally open push buttons or dry contact status (alarm, air conditioning, etc).

After you connected the wires in the right connectors you can assign the input functionality going through the **'Parameters'** window or through the **More.../Switches** menu

From the beginning all the input will be 'Not in use'. Click on it to change the functionality. You can control any Casambi devices.

To control the Jellyfish output click on 'Control an element' and select then the right output

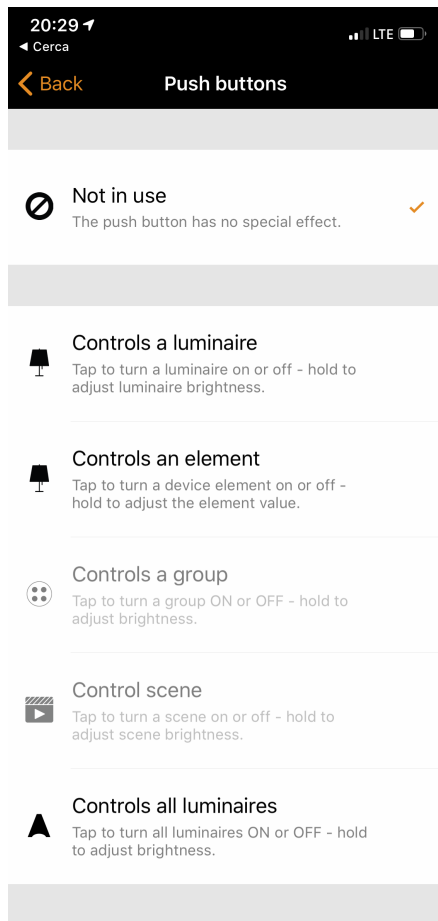

**9. Change the firmware**

If you need to change the firmware, go to the **Luminaires** menu and double click on the icon of Jellyfish.

At the bottom of Parameters you will find the **Unpair device** command. Perform it

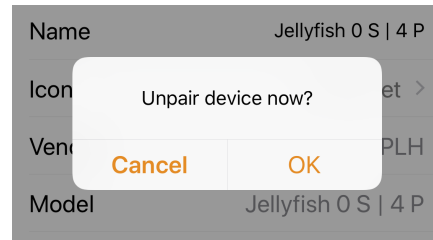

Now go on the **More.../Nearby** menu and click on the Jellyfish icon.

When you click on it the app will ask to 'Change profile' too.

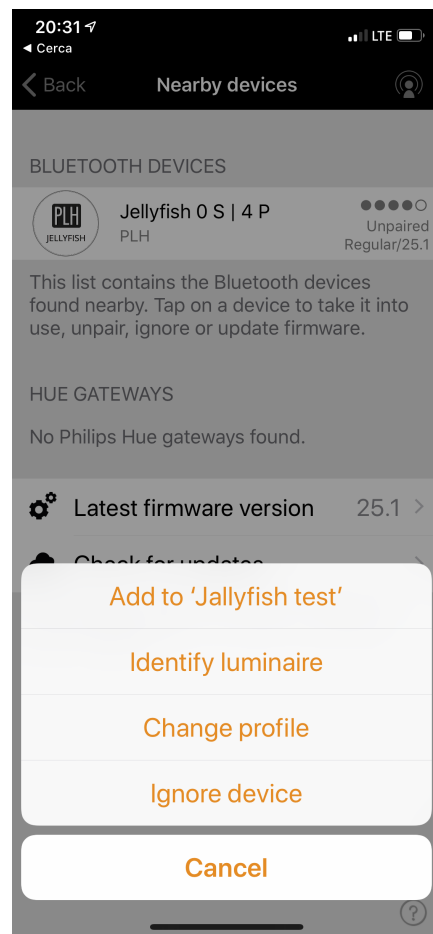

Change profile give you the chance to change the firmware, then the settings of the 4 outputs. Check the list on first page then select the desired profile

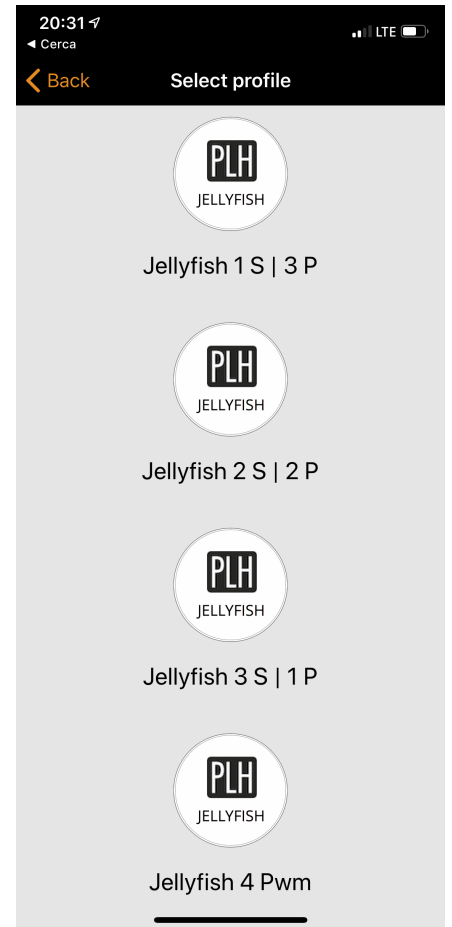

Add again the Jellyfish to your Network.

**Don't forget. Every time you perform this operation you will discards all the setups.**

**10. Update the firmware**

Time to time the firmware update window will appear for some maintenance stuff.

Then perform the update clicking on **Start update**

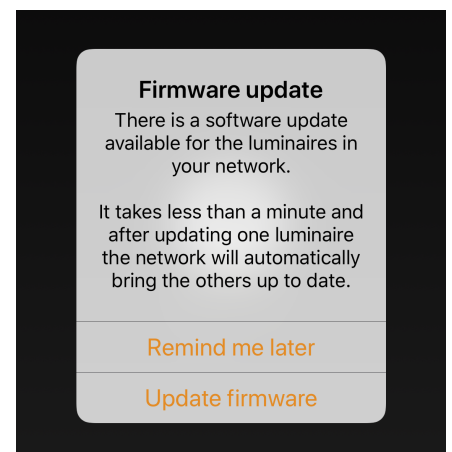

### 11. Control from other town

To be able to control the PLH Jellyfish from other town You need to have the right smartphone or tablet in the place where is located the PLH Jellyfish, in the signal range area, connected both to Internet (Wi-Fi) and to the Jellyfish (Bluetooth).

Then on the **More.../Setup** menù of the local smartphone or tablet activate the Gateway option.

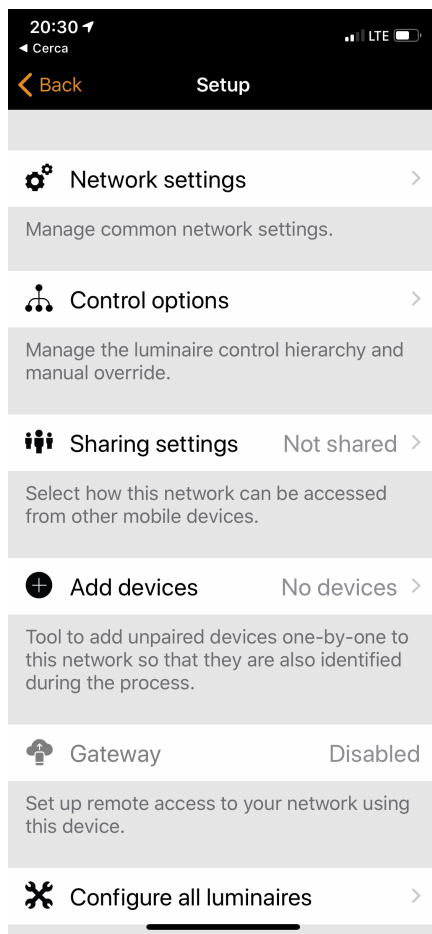

---

 [www.plhitalia.com](http://www.plhitalia.com)

 [info@plhitalia.com](mailto:info@plhitalia.com)

 [plhitalia](#)  
[#plhitalia](#)

 [@plhitalia](#)

 [PLH Italia](#)



Devices with soul.